

1919 LEVER TRIM-HANDING CHANGE INSTRUCTIONS

FIG. 1 (RIGHT HAND SHOWN)

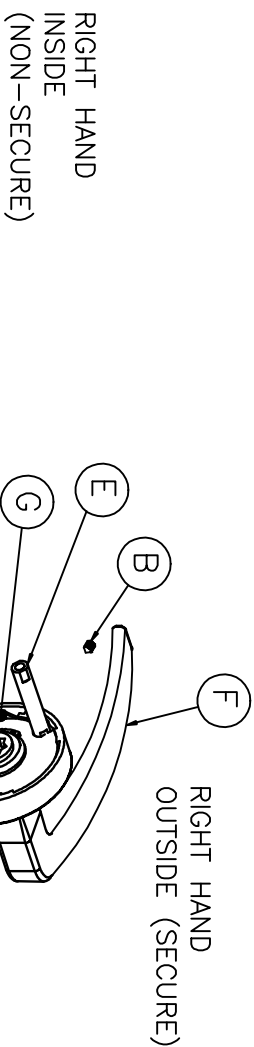

- A) INSIDE TRIM ASSEMBLY
- B) SET SCREW, LEVER (2 PCS)
- C) MOUNTING SCREWS (2 PCS)
- D) 1919 INSIDE MOUNTING BASE (NON-SECURED)
- E) 1919 OUTSIDE MOUNTING BASE (SECURED) WITH POSTS
- F) OUTSIDE TRIM ASSEMBLY
- G) SET SCREW, MOUNTING BASE M4 X 8mm LONG (1 PC)

STEP 1) CHANGE HANDING FROM RIGHT HAND (AS SHOWN ABOVE) TO LEFT HAND.

- a. LOCATE THE SECURED SIDE TRIM (F). THIS IS THE SIDE THAT HAS THE MOUNTING BASE "E" WITH POSTS ASSEMBLED TO THE ROSE AND LEVER TRIM.
- b. LOCATE AND REMOVE THE SMALL M4 X 8mm LONG SET SCREW "G", USING A 2mm HEX WRENCH.
- c. HOLDING THE ROSE FIRMLY, ROTATE THE OUTSIDE MOUNTING BASE "E" TO DISENGAGE MOUNTING BASE AND ROSE-LEVER ASSEMBLY BY ROTATING COUNTER-CLOCKWISE APPROXIMATELY 15 DEG.

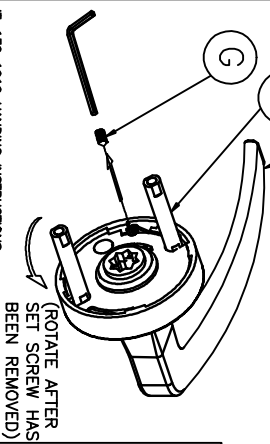

FIG. 2

STEP 2)

- a. LOCATE THE INSIDE TRIM "A" (LEVER AND ROSE), MAKING SURE THE LEVER "ARC/HANDING" IS THE CORRECT TRIM.
 - b. INSERT THE OUTSIDE MOUNTING BASE "E" WITH THE POSTS AND ROTATE CLOCKWISE APPROXIMATELY 15 DEG. UNTIL THE TRIM MOUNTING BASE IS SEATED CORRECTLY.
 - c. RE-INSERT THE M4 X 8mm SET SCREW "G".
- NOTE: DO NOT TIGHTEN! INSERT UNTIL IT IS FLUSH WITH THE MOUNTING BASE SURFACE.

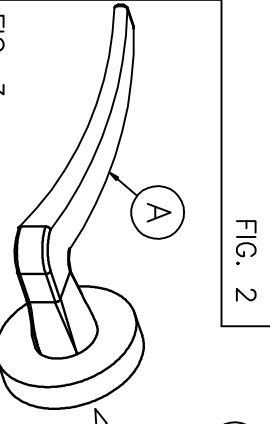
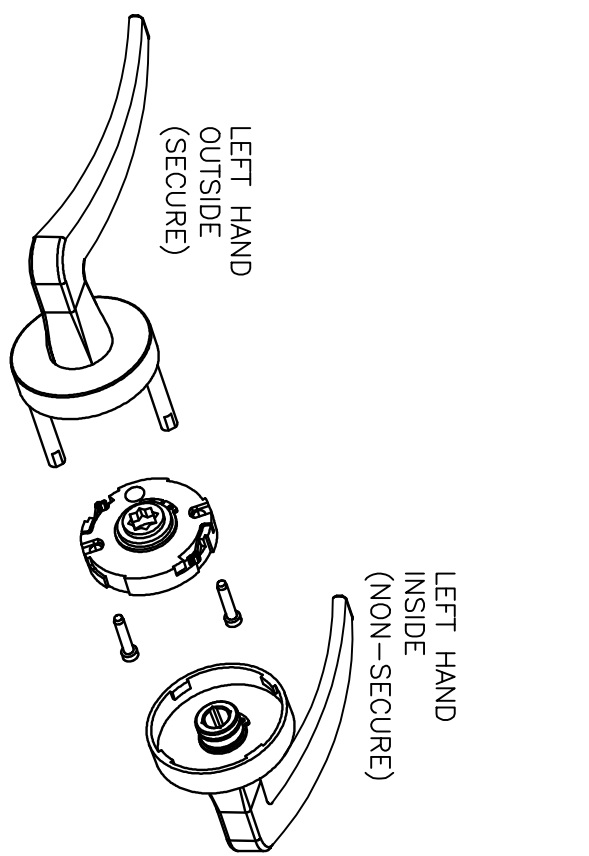

FIG. 3

- STEP 3)
- a. THE TRIM ASSEMBLY AFTER THE HANDING CHANGE. THE LEFT HAND "OUTSIDE" NOW BECOMES THE SECURE SIDE. THE "INSIDE" IS NOW THE NON-SECURE SIDE.
- b. PROCEED USING IT-124 FOR INSTALLATION INSTRUCTIONS.



STEP 4)
a. TO CONVERT BACK TO RIGHT HAND, REVERSE PROCESS TO MATCH ILLUSTRATION-1.

FIG. 4

